

(A) 1050 mm high dispensing counter. 12 mm thick Korean acrylic sheet to be used for counter on 25 mm thick commercial ply. Display unit with 18 mm thick laminated shelf's to be inbuilt in counter as/design.

D. (B) 2400 mm high storage unit. 600 mm deep and 1200mm wide laminated storage unit with 8mm thick toughened glass shelves. Shutters at bottom and top fixed with auto hinges to be provided. The ht. of 600mm deep storage shall be 750mm. 350mm deep storage unit to be fixed between two 150mm wide laminated facia. 330 mm wide 8mm thick toughened glass shelves to be fixed with bracket till 2100mm. In built overhead unit of 350 mm depth 300 mm height to be fixed above 2100mm ht. as /design

(C) Linear Work station (1200 x 600)

(D.) Movable counter with castor wheels.

NOS.	DATE	DESCRIPTION	DWN	CK

CLIENT



PROJECT TITLE

PROPOSED AMRIT PHARMACY
AT AIIMS PATNA

CLIENT'S SIGNATURE

ARCHITECT'S SIGNATURE

DRAWING TITLE

PROPOSED LAYOUT PLAN

DATE: 17-06-2016

SCALE 1:100

DRG. NUMBER

AMR/ PAT /001

REV.

001

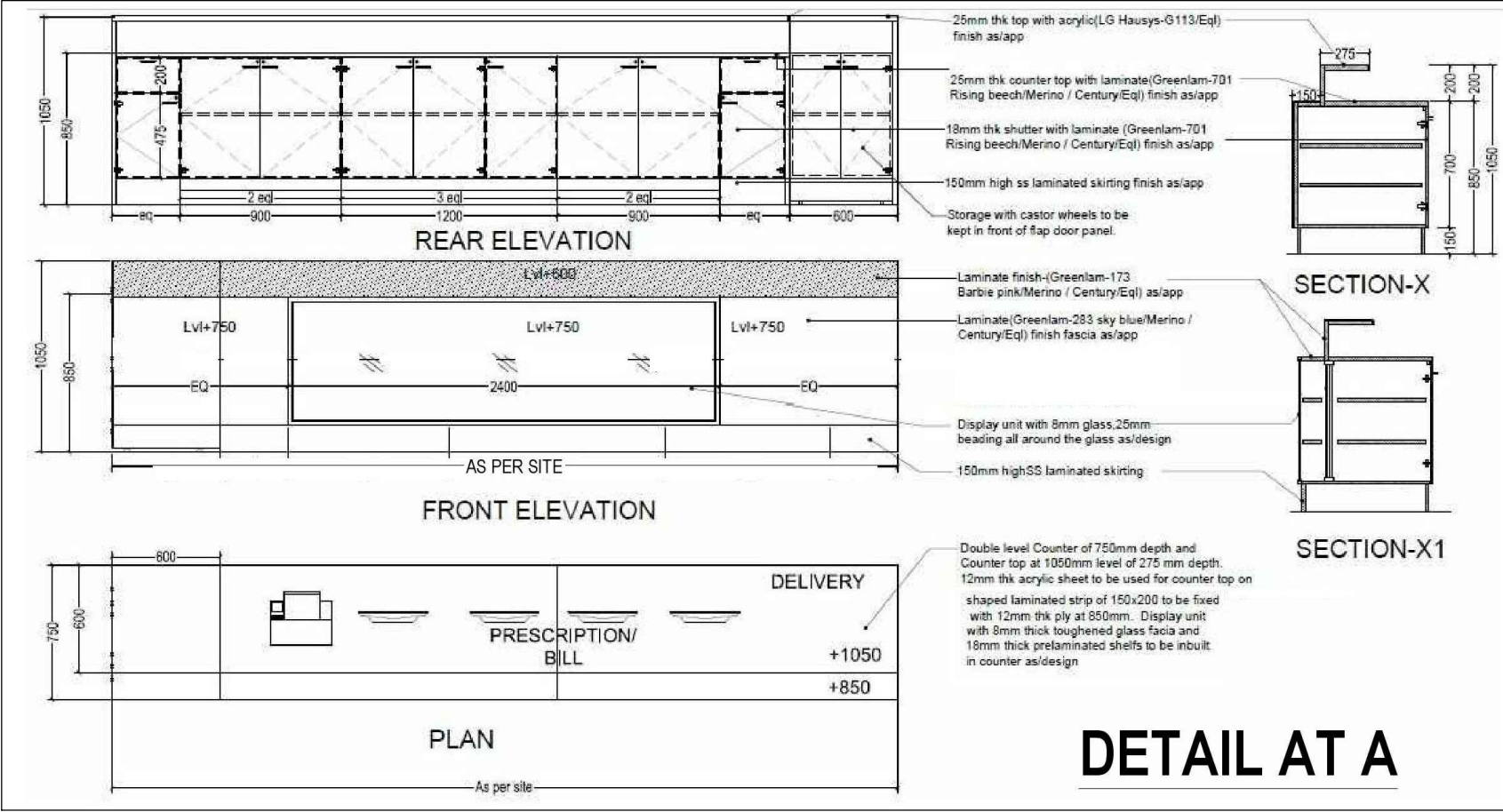

DETAIL AT A

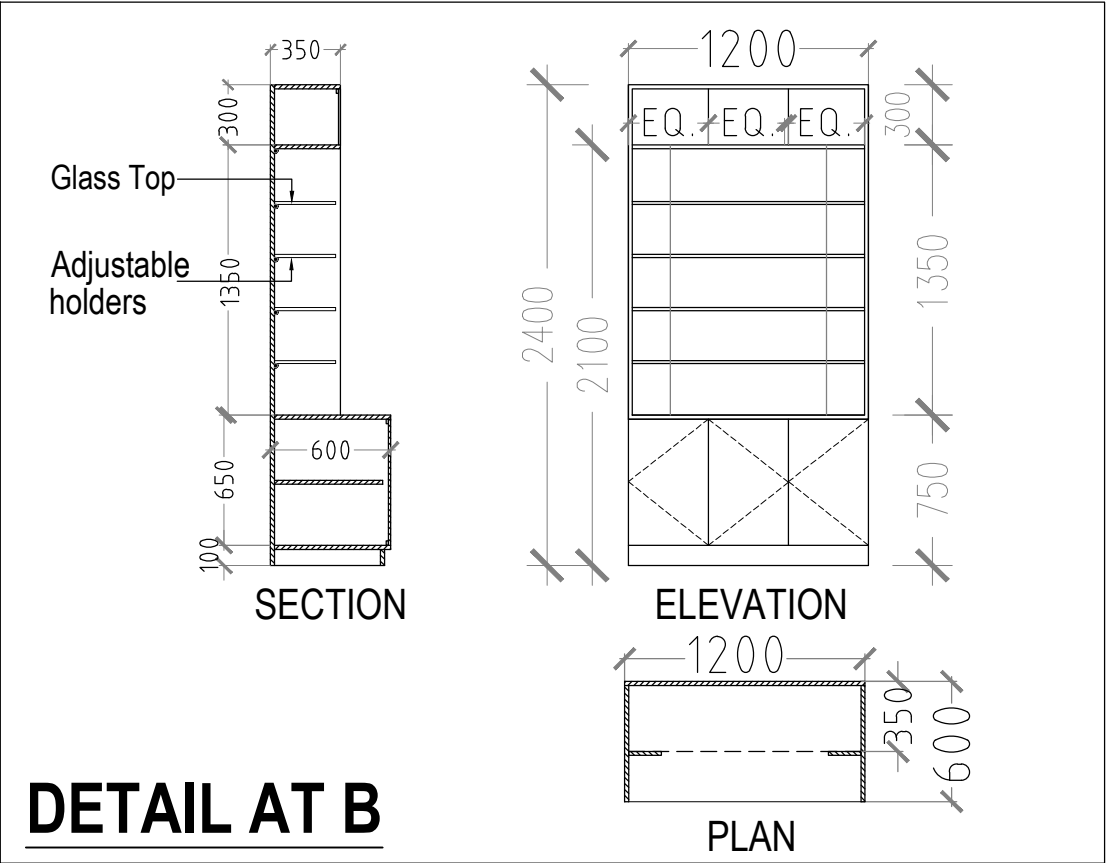

DETAIL AT B

NOS.	DATE	DESCRIPTION	DWN	CKD.
R E V I S I O N S				

CLIENT



PROJECT TITLE

PROPOSED AMRIT PHARMACY
AT AIIMS PATNA

CLIENT'S SIGNATURE	ARCHITECT'S SIGNATURE

DRAWING TITLE

FURNITURE DETAIL

DATE: 17-06-2016

SCALE

DRG. NUMBER	REV
AMR/ PAT/003	004